



High Voltage Rectifier Diode
Reverse Voltage - 1200 Volts
Forward Current - 8 Amperes

Features

- Hireliability application and automotive grade AEC-Q101 qualified
- Very low leakage current
- Very low forward voltage drop
- High voltage rectifier
- High surge current capability

Mechanical Data

- Case: TO-220-3L
- Approx. Weight: 2.04g (0.07oz)
- Terminals: Lead solderable per MIL-STD-202, Method 208
- Lead free finish, RoHS compliant
- Case Material: “Green” molding compound, UL flammability classification 94V-0, “Halogen-free”.

TO-220-3L

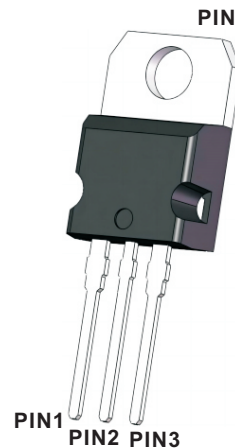

RoHS
COMPLIANT

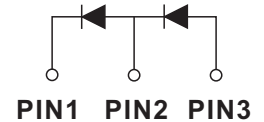

Packing Marking And Ordering Information

Device Package	Device	Marking	Packing Type	QTY Per Tube	Inner box	Per Carton
TO-220-3L	GR8120CL	GR8120CL	Tube	50 Pcs	2,500 Pcs	5,000 Pcs

Maximum Ratings And Electrical Characteristics

Ratings At 25°C Ambient Temperature Unless Otherwise Specified

Parameter	Symbols	AT-GR8120CL	Units
Max. Repetitive Reverse Blocking Voltage	V_{RRM}	1200	V
Max. Non-repetitive Reverse Blocking Voltage	V_{RSM}	1300	V
Average Forward Current	$I_{F(AV)}$	8	A
Max Forward Voltage Drop	$I_F=8A$ $I_F=16A$	1.2 1.4	V
Max Reverse Current @ $V_R=1200V$	$T_J=25^{\circ}C$ $T_J=150^{\circ}C$	10 200	μA
Max Forward Surge Current	$t=10ms(50Hz)$ sine $t=8.3ms(60Hz)$ sine	120 130	A
Value For Fusing	$t=10ms(50Hz)$ sine $t=8.3ms(60Hz)$ sine	72 70	A^2s
Typical Thermal Resistance Junction to Case	R_{thJC}	1.5	$^{\circ}C/W$
Virtual Junction Temperature	T_{VJ}	-55 ~ +175	$^{\circ}C$
Operation Temperature	T_{OP}	-55 ~ +150	$^{\circ}C$
Storage Temperature	T_{STG}	-55 ~ +150	$^{\circ}C$



Fig.1 Typical Forward Current Derating Curve

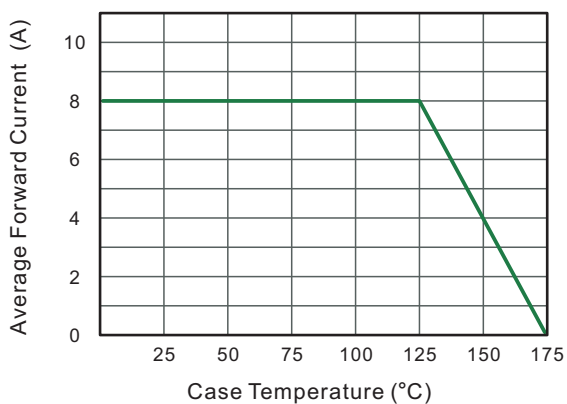

Fig.2 Typical Reverse Characteristics

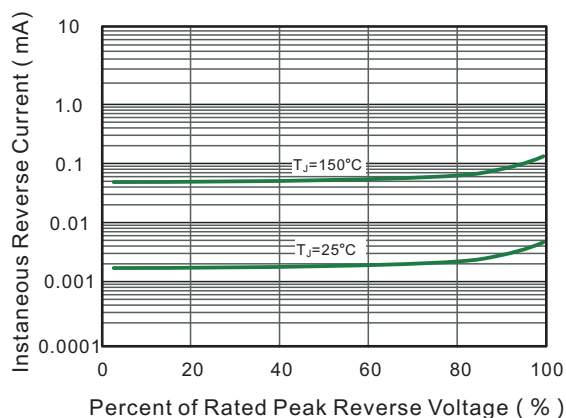

Fig.3 Typical Forward Characteristic

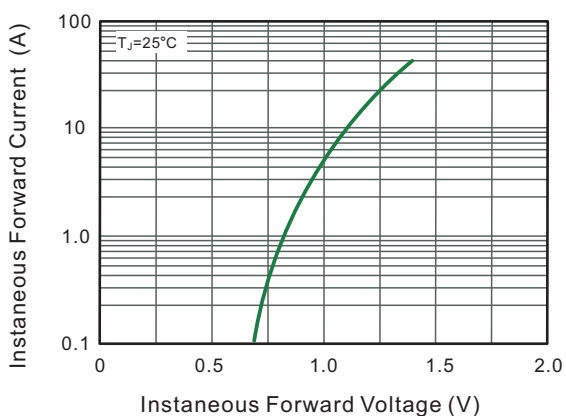
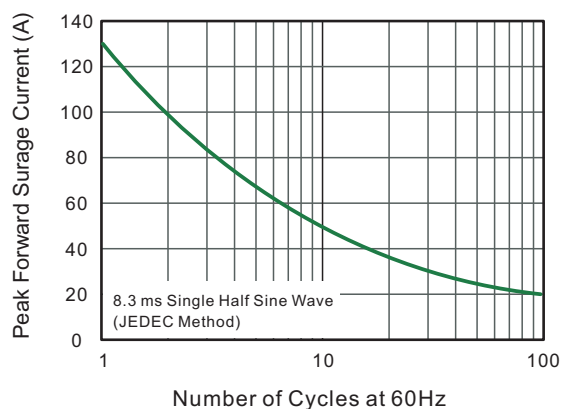

Fig.4 Maximum Non-Repetitive Peak Forward Surge Current





Package Outline
Through Hole Package ; 3 leads

TO-220-3L

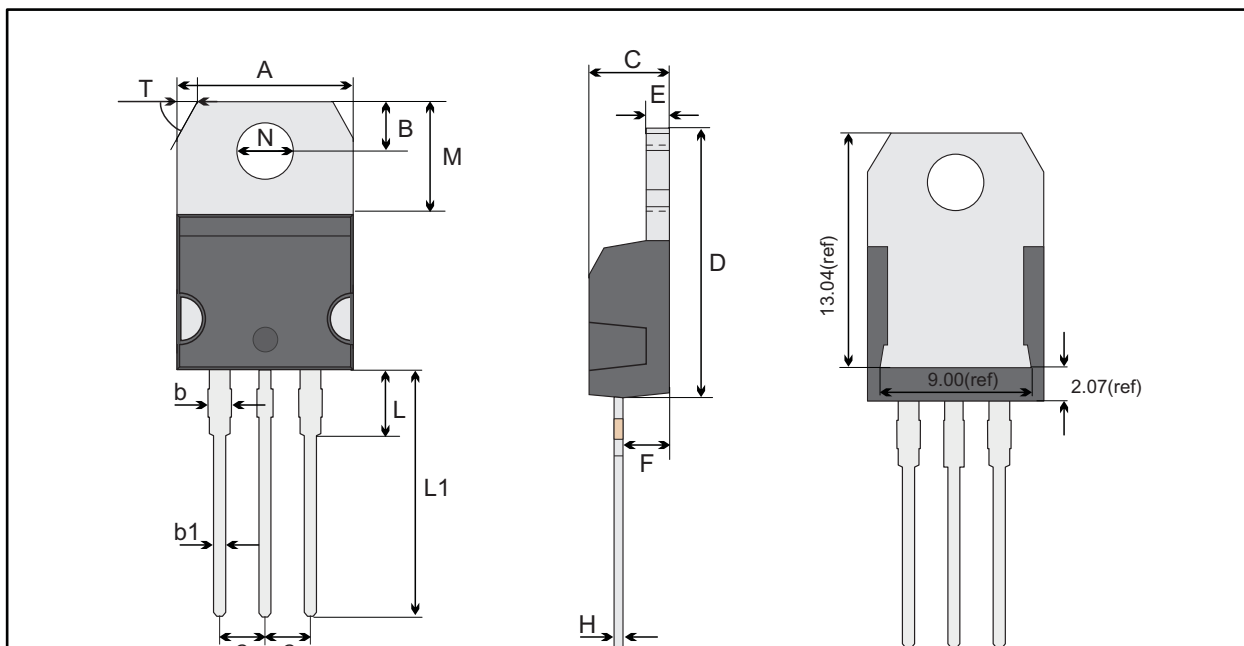

TO-220-3L mechanical data

UNIT		A	B	b	b1	C	D	E	F	G	H	L	L1	M	N	T
mm	max	10.28	2.84	1.67	0.9	4.65	15.54	1.37	2.79	2.64	0.6	3.88	13.13	6.39	3.82 typ.	1.19 58° ref.
	typ	10.18	2.74	1.47	0.8	4.45	15.34	1.27	2.59	2.54	0.5	3.68	12.93	6.19		
	min	10.08	2.64	1.27	0.7	4.25	15.14	1.17	2.39	2.44	0.4	3.48	12.73	5.99		
mil	max	405	112	66	35	183	612	54	110	104	24	153	517	252	150 typ.	47 58° ref.
	typ	401	108	58	31	175	604	50	102	100	20	145	509	244		
	min	397	104	50	28	167	596	46	94	92	16	137	501	236		

Marking Diagram

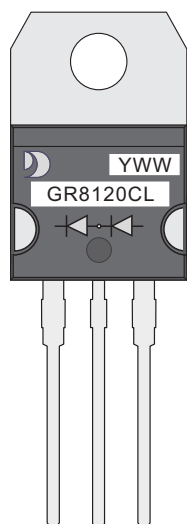

YWW: Date Code
Y:Years(0~9)
WW:Week
GR8120CL: Product name
(NOTE:The weekly code is based on the actual number of weeks in the calendar year.)



Important Notice and Disclaimer

Jingdao Microelectronics reserves the right to make changes to this document and its products and specifications at any time without notice. Customers should obtain and confirm the latest product information and specifications before final design, purchase or use.

Jingdao Microelectronics makes no warranty, representation or guarantee regarding the suitability of its products for any particular purpose, not does Jingdao Microelectronics assume any liability for application assistance or customer product design.

Jingdao Microelectronics does not warrant or accept any liability with products which are purchased or used for any unintended or unauthorized application.

No license is granted by implication or otherwise under any intellectual property rights of Jingdao Microelectronics.

Jingdao Microelectronics products are not authorized for use as critical components in life support devices or systems without express written approval of Jingdao Microelectronics.