



1A SURFACE MOUNT BRIDGE RECTIFIER

FEATURES:

- Reverse Voltage - 2000 V
- Forward Current - 1 A
- High Surge Current Capability
- Designed for Surface Mount Application

MECHANICAL DATA

- Case: SOP-B
- Terminals: Solderable per MIL-STD-750, Method 2026
- Approx. Weight: 120mg/0.0042oz

PINNING

PIN	DESCRIPTION
1	Input Pin (~)
2	Input Pin (~)
3	Output Anode (+)
4	Output Cathode (-)



Maximum Ratings and Electrical characteristics

Ratings at 25 °C ambient temperature unless otherwise specified.

Single phase half-wave 60 Hz, resistive or inductive load, for capacitive load current derate by 20 %.

Parameter	Symbols	LT4P20-10	Units
Maximum Repetitive Peak Reverse Voltage	V_{RRM}	2000	V
Maximum RMS voltage	V_{RMS}	1400	V
Maximum DC Blocking Voltage	V_{DC}	2000	V
Average Rectified Output Current at $T_c = 125\text{ }^\circ\text{C}$	I_o	1	A
Peak Forward Surge Current 8.3 ms Single Half Sine Wave Superimposed on Rated Load (JEDEC Method)	I_{FSM}	30	A
Maximum Forward Voltage at 1.0 A	V_F	1.2	V
Maximum DC Reverse Current at Rated DC Blocking Voltage @ $T_A=25\text{ }^\circ\text{C}$ @ $T_A=125\text{ }^\circ\text{C}$	I_R	1 100	μA
Typical Junction Capacitance (Note1)	C_j	20	pF
Operating and Storage Temperature Range	T_j, T_{stg}	-55 ~ +150	$^\circ\text{C}$

Note: 1. Measured at 1MHz and applied reverse voltage of 4 V D.C.



Fig.1 Average Rectified Output Current Derating Curve

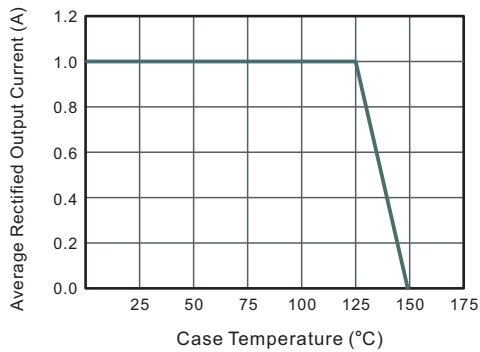

Fig.2 Typical Reverse Characteristics

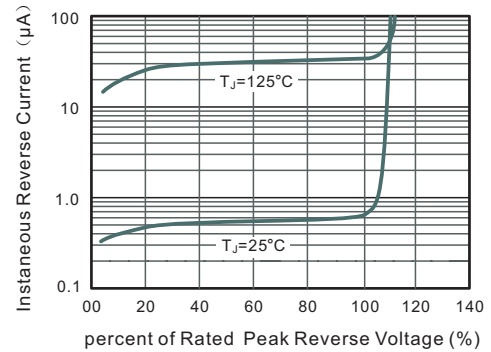

Fig.3 Typical Instantaneous Forward Characteristics

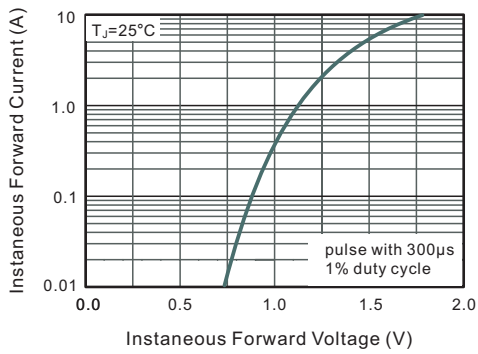

Fig.4 Typical Junction Capacitance

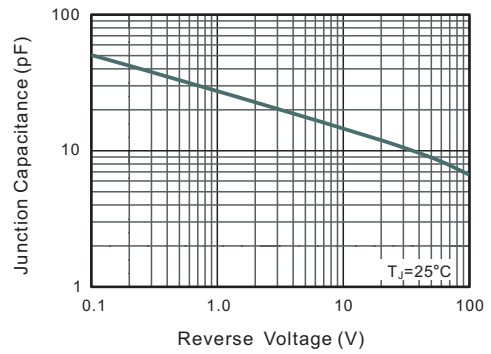
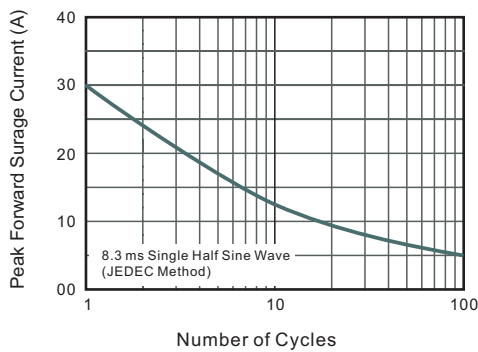

Fig.5 Maximum Non-Repetitive Peak Forward Surge Current





PACKAGE OUTLINE

Plastic surface mounted package; 4 leads

SOP-B

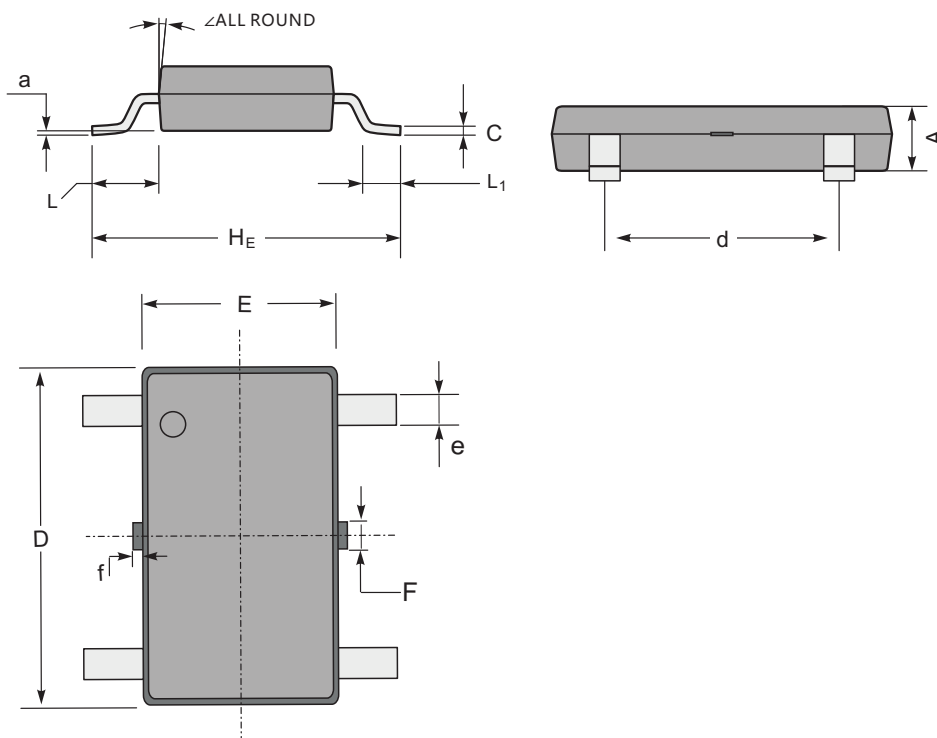

SOP-B mechanical data

UNIT		A	C	D	E	H _E	d	e	L	L ₁	a	F	f	∠
mm	max	1.25	0.22	6.3	4.1	6.1	5.0	0.8	1.15	0.8	0.2 ref.	0.8 TYPI CAL	0.3 TYPI CAL	12°
	min	1.05	0.15	6.1	3.6	5.9	4.6	0.5	0.95	0.4				
mil	max	49	8.7	248	161	240	197	31	45	32	8 ref.	32 TYPI CAL	12 TYPI CAL	
	min	41	5.9	240	142	232	181	20	37	15				

The recommended mounting pad size

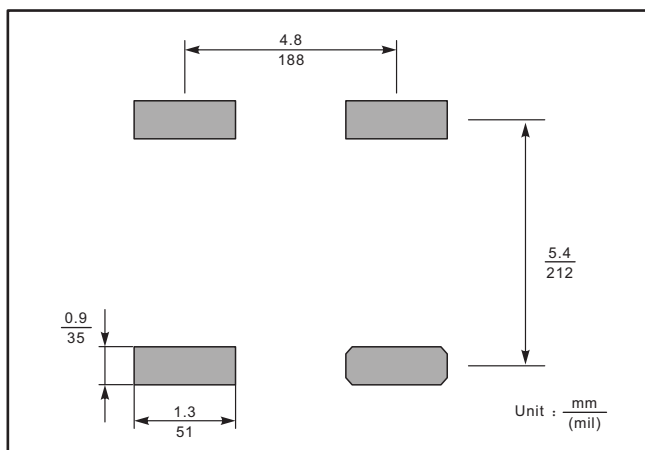

Marking

Type number	Marking code
LT4P20-10	LT4P20-10